

PSN(C,V) - 40 系列 壓力傳感器

配件尺寸圖

氣立可空氣壓設備

◎ 固定腳架

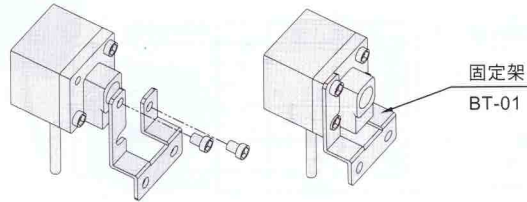

◎ BT - 01 直立固定型

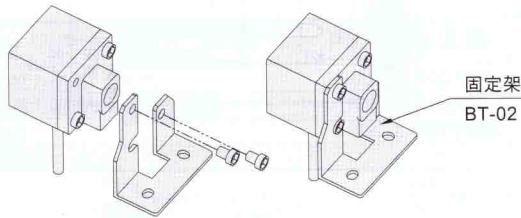
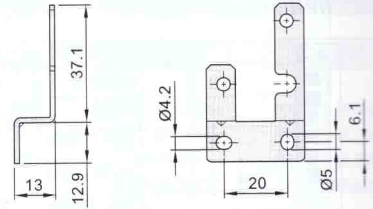

◎ BT - 02 垂直固定型

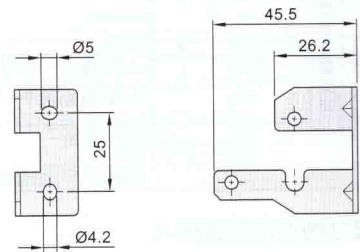

◎ 面板式固定組合 - FC

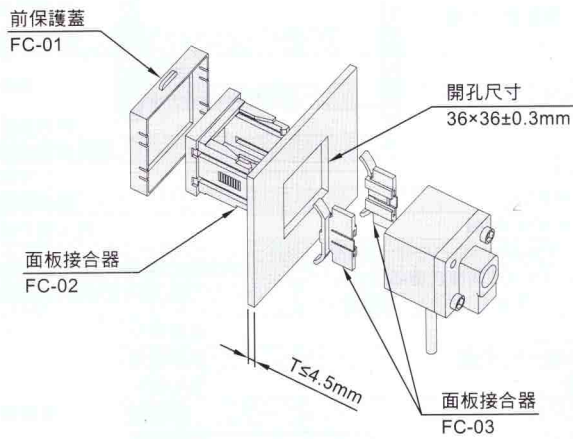

◎ FC-01 前保護蓋

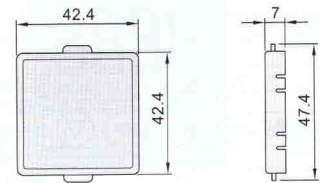

◎ FC-02 固定座

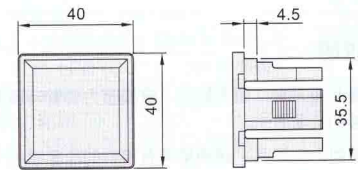

◎ FC-03 固定片

